

# MALTA TOWNSHIP SECTION 23 R-12 TWP-10 MORGAN COUNTY, OH

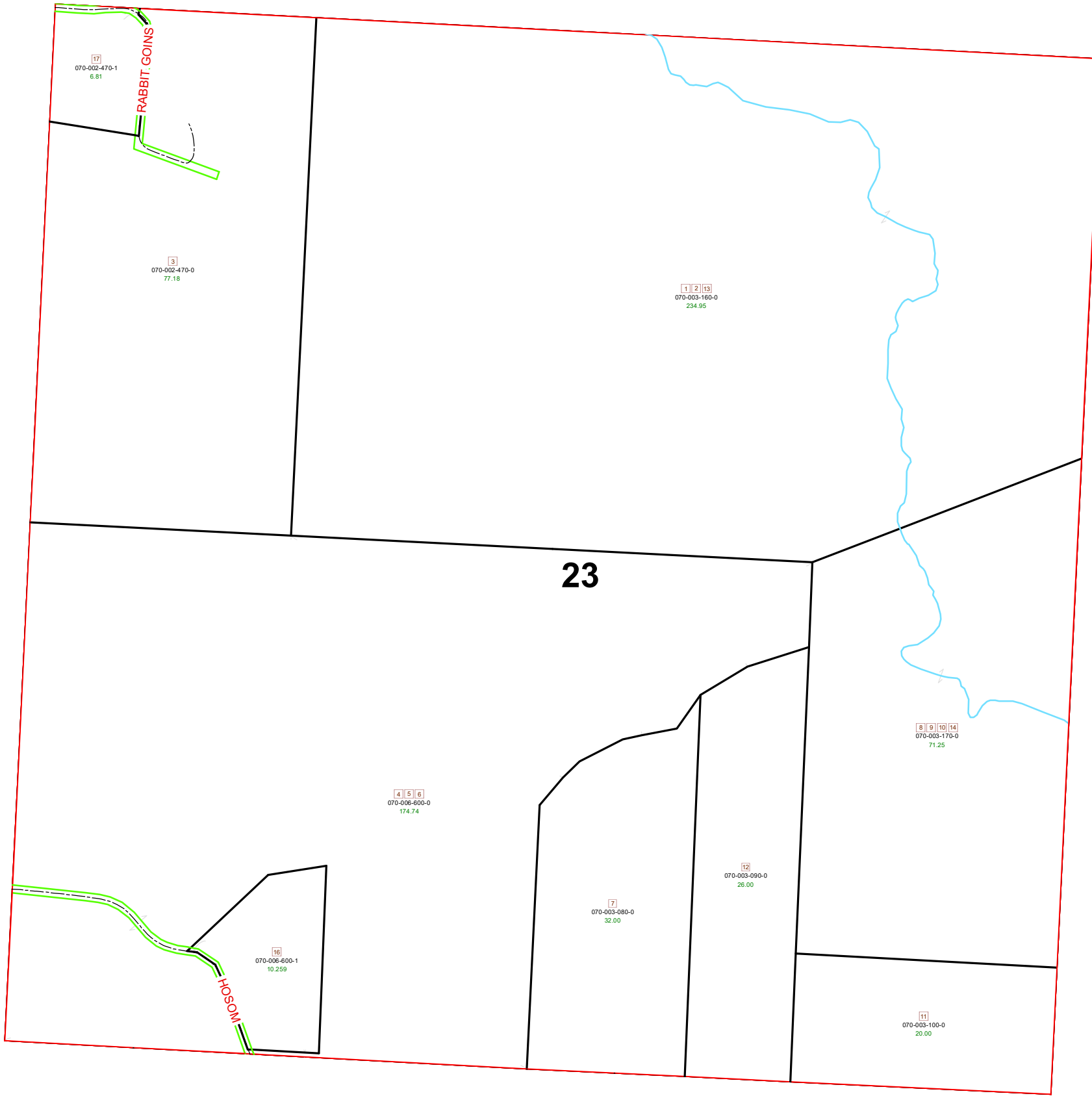

PIN	VOL	PAG	Owner	LegalDescr	Acres
070-006-600-1	OR232	3589	DAWSON BRIAN A	R12 T10 S23 SD 16	10.259
070-002-470-0	OR204	3371	GOINS JERRY HAYWARD TRUSTEE	R12 T10 S23 SD 03	77.189
070-002-470-1	OR192	535	GOINS ROGER L & MARY M	R12 T10 S23 SD 17	6.811
070-003-100-0	OR21	502	HIPP LIMITED PARTNERSHIP	R12 T10 S23 SD 11	20
070-003-090-0	OR21	502	HIPP LIMITED PARTNERSHIP	R12 T10 S23 SD 12	26
070-003-080-0	OR21	506	HIPP LIMITED PARTNERSHIP	R12 T10 S23 SD 7	32
070-003-160-0	OR21	502	HIPP LIMITED PARTNERSHIP	R12 T10 S23 SD 1-2	234.95
070-003-170-0	OR21	502	HIPP LIMITED PARTNERSHIP	R12 T10 S23 SD 8-9	71.25
070-006-600-0	OR107	497	WEAVER JASON & AMBER	R12 T10 S23 SD 4-5	174.741

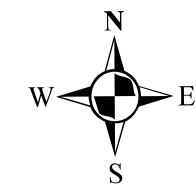

Boundaries	
-----	Hidden
-----	Roads
-----	County
-----	Parcel
-----	Parcels
-----	Lot
-----	Hydro
-----	Section
-----	Township
-----	ROW

